



## RGS-SI and RGS-SI TWIN FIRE-SOUNDPROOF SCROLLING SHUTTER Trouble-free service and convenience

Fire-soundproof scrolling shutters are custom-made according to the customer's dimensional requirements. They are tested according to European standards (ČSN EN) and can be supplied in various versions.

Thanks to its simple structural design, the installation takes up a minimal amount of space. The horizontal lamellas, manufactured from high-quality galvanized zinc-plated sheet profiles, are joined together by a locking joint. The lateral guide rails ensure smooth vertical movement of the scrolling shutter. The doorjamb and header are lined with an insulation profile produced from an intumescent material.

### TYPES OF SCROLLING SHUTTERS

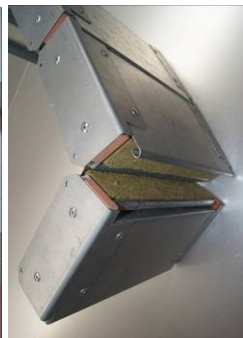

#### Insulated RGS-60-SI and RGS-60-SI TWIN

EI 60 to EW 180 DP1-C3

- RGS-60-SI – weighted sound reduction  $R_w$  36 dB
- RGS-60-SI TWIN – weighted sound reduction  $R_w$  55 dB (double scroll steel shutter)
- insulated lamellas each 150 mm tall and 60 mm thick with a perfectly interrupted thermal bridge
- insulation density of  $30 \text{ kg/m}^3$  for the EI 60 class door
- considering the large diameter of the rolled-up shutter, the motor is always placed outside the drum and power is transferred through cog wheels placed on the shafts of the drum and motor
- individual lamellas can be fitted during the installation
- can also be used for sound insulation
- diameter of rolled-up shutter: 670–950 mm
- certified without requiring a cover for the rolled-up shutter

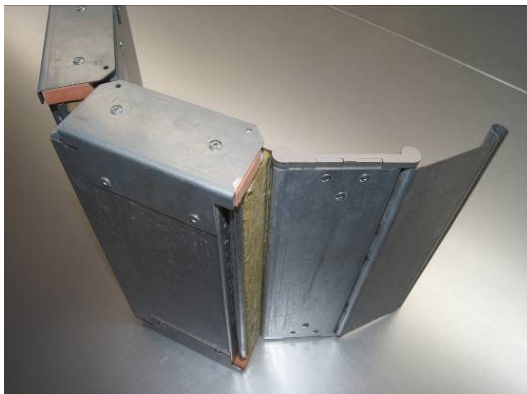

#### Fire shutters RGS-60-SI and RGS-60-SI TWIN - „Horizontal“

- combination of insulated and non-insulated lamellas that slide horizontally with a perfectly interrupted thermal bridge for the insulated lamellas
- the non-insulated lamellas, which are scrolled onto the drum, drag the insulated lamellas along a horizontal steel structure (similar to sectional doors)
- benefit of maintaining a low head (450 mm) and high fire resistance for doors
- the motor shaft can be attached directly to the shaft of the main drum (does not apply for FS motors)
- diameter of rolled-up shutter: 310 – 500 mm
- high standard parameters of shutters were verified in accredited laboratory
- certified by authorized institute





## SURFACE FINISHING



### Zinc-plated

- plating with high-quality galvanized zinc-plated sheets, which need no further surface treatment
- considering the nature of scrolling shutters, which cause the lamellas to rub against one another, no guarantee against damage to the coating can be provided



### Color coating

- RAL according to the purchaser's selection – Individual lamellas are delivered already painted
- considering the nature of scrolling shutters, which cause the lamellas to rub against one another, no guarantee against damage to the coating can be provided

## GATE CONTROL



### FS (Fail Safe) motor with FSTronic control

- industrial motor with long cycle life up to 100,000 cycles
- 3x400 V/10 A supply
- under normal operation, the motor opens and closes the gate
- in case of an alarm, the gate closes by gravity (fail-safe)
- the gate cannot be opened mechanically
- power must be transferred from the motor to the drum by a drive chain



### FDF motor with FSTronic 24 control

- industrial motor with long cycle life up to 100,000 cycles
- 3x400 V/10 A supply
- under normal operation, the motor opens and closes the gate
- in case of an alarm, the gate is closed by means of a 24 V DC battery powered reserve motor
- the gate can be opened mechanically

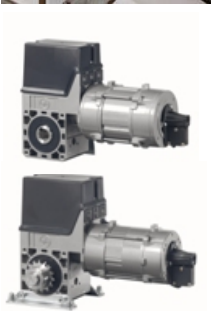

### KE motor with 6RM4 control

- industrial motor with long cycle life up to 100,000 cycles
  - KE motor is intended for RGS-60 and power is transferred to the drum by a drive chain
  - 1x230 V/20 A supply
  - under normal operation, the motor opens and closes the gate
  - smooth operation thanks to the frequency inverter increases the life of the gate
  - speed can be easily regulated on the frequency inverter
  - in case of an alarm, the motor closes the gate by means of the UPS emergency power supply
  - the gate can be opened mechanically
  - optionally, the gate can be opened electronically from the UPS emergency power supply
- If this option is required, it is necessary to contact the manufacturer to determine the size of the UPS (standard UPS sized only for closing).

Would you like to know more? Contact us.

### Somati system s.r.o.

Jihlavská 510/2c, 664 41 Troubsko  
tel: +420 547 427 011

e-mail: [export@somati-system.cz](mailto:export@somati-system.cz)

[www.somati-system.cz](http://www.somati-system.cz)

[www.facebook.com/somatismystem](https://www.facebook.com/somatismystem)

**Somati**  
**system s.r.o.**

